

DYNAMIC[™]
LEARNING MAPS

**Guide to Retrieving Student Usernames and
Passwords
2018-2019**



Revision: August 28, 2018

Version: 3.0

Retrieving Student Username and Password

1. Click Manage Tests.

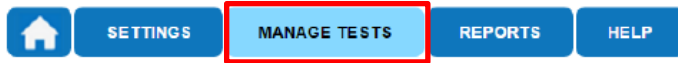

2. Click Test Management.



3. Click Search. A list of test sessions will display.

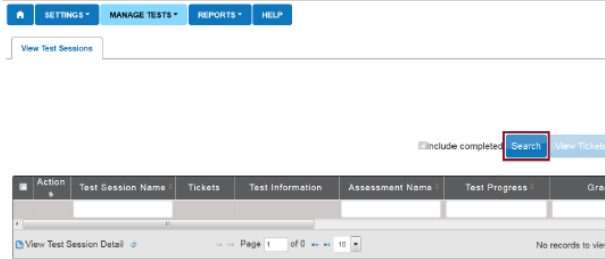

4. Click the PDF Icon under Tickets next to the name of the desired test.

Test Session Name	Tickets	Test Information	Roster	Test Progress	Scho
				4 out of 5	001 De
				3 out of 5	001 De

5. Click Open with; choose Adobe Acrobat.

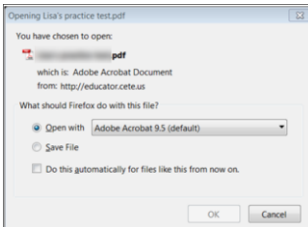

6. Click Ok.

7. View the student username and password.

